



AIR FLOW LAB

NAME OF PIC : AZIZUL HAKIM ABU HASSAN

POST: ASSISTANT ENGINEER



: 3136 / 019 - 2060972

Email: azizulh@iium.edu.my



Introduction

The lab is used as classroom for certain courses:

- **Architecture** - Subject related to structure and building construction
- **Quantity Surveying** - Related to structure, building construction, civil engineering construction and studio
- **Applied Arts and Design**

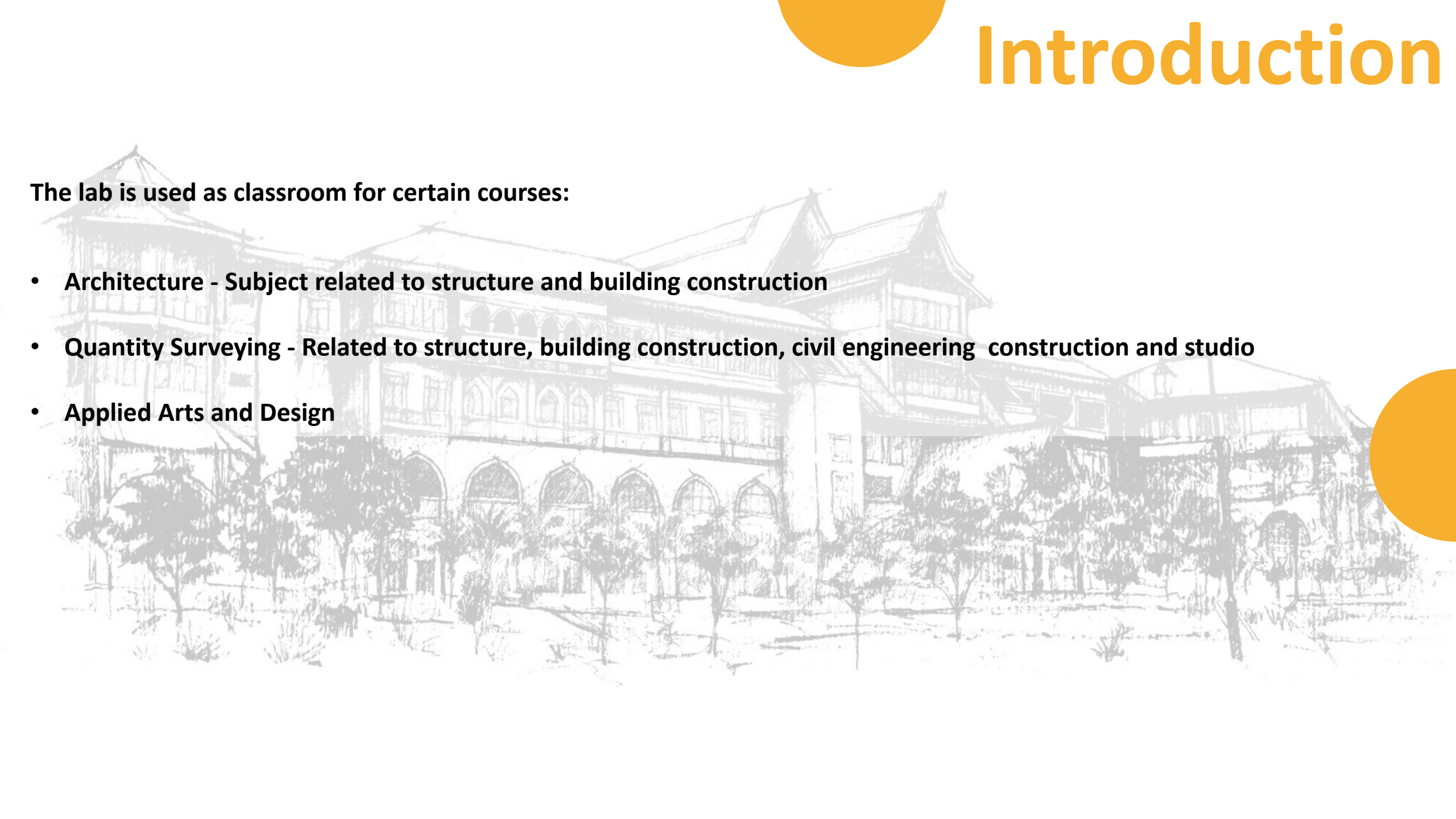

List of equipment

Equipment	Item	Purpose
The Armfield Laminar Flow Table		Has been designed to stimulate ideal fluid flow and give clear visualization of the flow pattern created using water as the working fluid this enables a comprehensive investigation into the principal of potential flow and allows modelling of appropriate physical system.

Sample of product / work

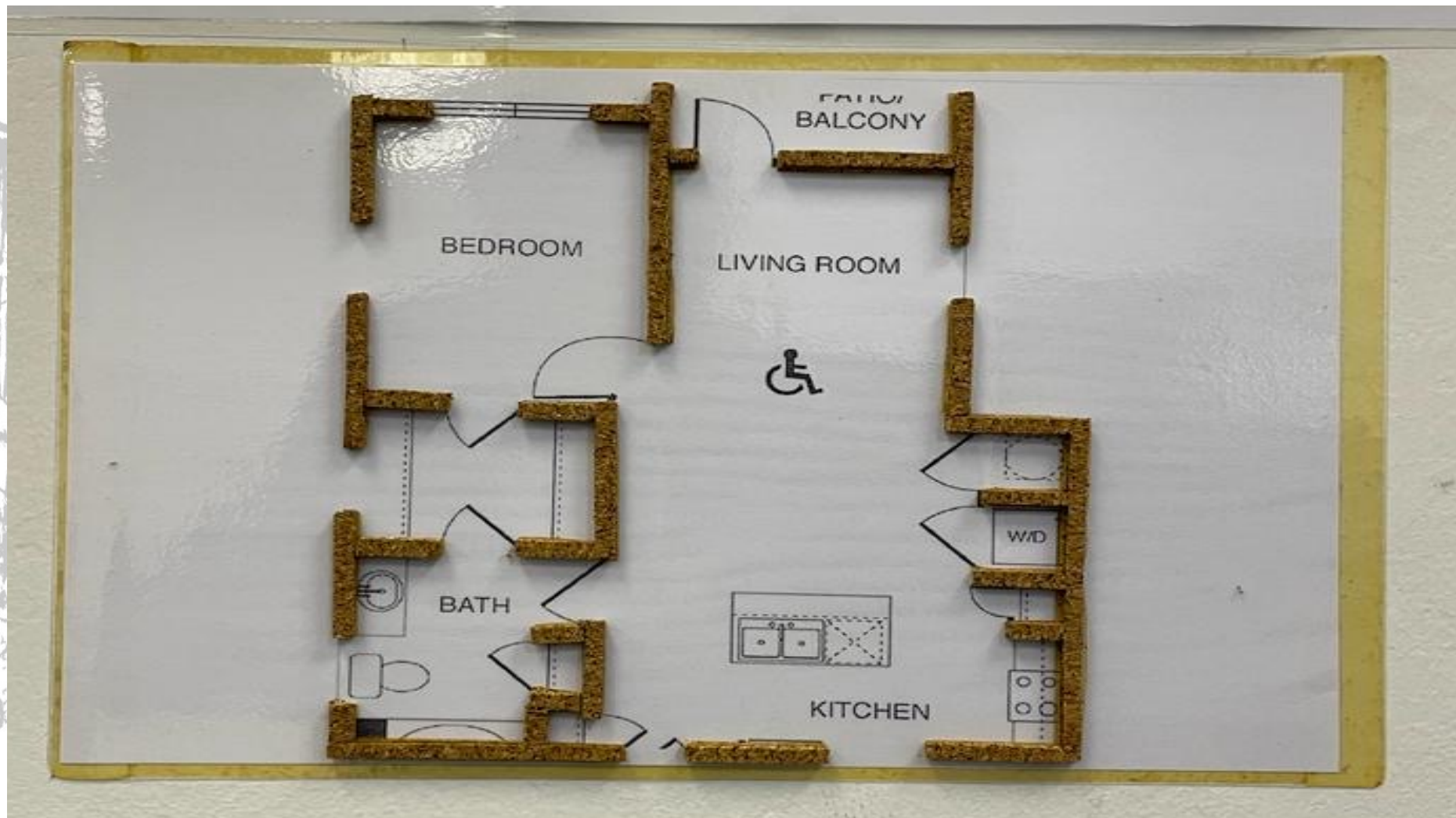

Opening Hours

Monday to Thursday

8.00am – 1.00pm

2.00pm – 5.00pm

Friday

8.00am – 12.15pm

2.45pm – 5.00pm

Non-working hours

Kindly contact
person in charge

